

Tri-Axial Accelerometer

Features:

- IC Inside
- Center Mount
- Tri-Axial Measurements
- 3-M5 Output

Model AI152

Specifications:

Dynamic Characteristics

Axes Sensitivity (20±5 deg C)	~20 mV/g
Measurement Range	250 g
Max Transverse Sensitivity	<5%
Frequency Response (5%)	1 - 4000 Hz
Resonance Frequency	15,000 Hz
Temperature Response	See temperature curve
Polarity	Positive

Electrical Specifications

Voltage Supply	+12 ~ 28V _{DC}
Current	+2 ~ +10 mA
Max Signal Output	<5V _P
Output Impedance	< 100 Ω
Bias Voltage	7+/- 1 V _{DC}
Noise (1~20KHz)	< 2mg

Environmental/Physical Characteristics

Temperature Range	-20 to + 120 °C
Shock Limit	500g
Weight	90g
Case Material	Stainless Steel
Mounting	M5 Screw
Piezo Material	PZT-5
Structure	Cut mode

Included Accessories	Calibration sheet
	M5 screw x 2
	L5 STYV-1(2n) x 3

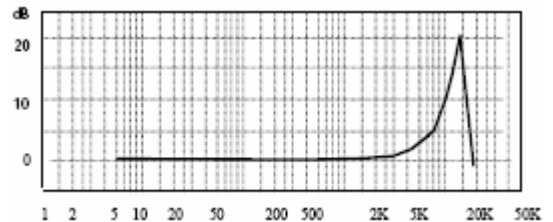
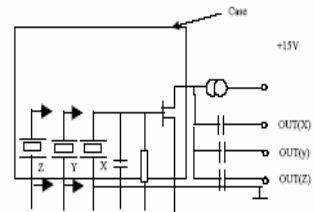
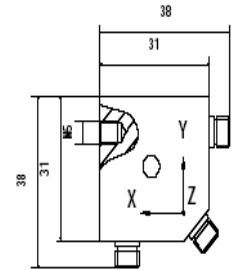

Frequency Response Curve

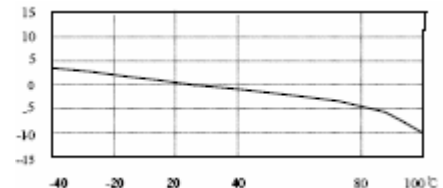

Temperature Curve

Product information:
KCF Technologies, Inc.
www.kcftech.com
 112 W. Foster Avenue
 State College, PA 16801
 TEL: 814-867-4097
 FAX: 814-690-1579

North American Sales & Support:
Scantek Inc.
www.scantekinc.com
 7060 Oakland Mills Road, Suite L
 Columbia, MD 21046
 TEL: 410-290-7726
 FAX: 410-290-9167